



The diagram shows a 3x1 grid of rectangles. The top row is labeled '1' and the bottom row is labeled '2'. The columns are labeled 'A', 'B', and 'C' at the top. The height of the rectangles is 1.00. The width of each rectangle is 1.50. The total width of the grid is 4.50.

VIGA CADENA

The drawing shows a side elevation of a staircase. The total height of the staircase is 4.50. The height of the landing area is 0.40. The height of the staircase flight is 3.80. The width of the staircase is 0.70. The drawing also shows a section of the staircase with a width of 0.40. The drawing is labeled 'Escalera' and 'PISO ACABADO'. The drawing is also labeled 'VIGA CADENA' and 'SOLADURA DE PIEDRA'. The drawing is also labeled '0.00 TERRENO NATURAL'.

EJES
CANTIDAD
PLANTA BAJA

EJES	TODOS
CANTIDAD	8
PLANTA BAJA	

LOSA RADIER

Technical drawing of a rectangular structure. The top view shows a rectangle with a width of 1.50 and a length of 3.50. The front view shows a rectangle with a height of 1.50. The drawing is labeled with 'POS. 2' at the top and 'POS. 1' at the bottom. The drawing is oriented horizontally.

TIPO	CANT.	A	B	H	POS.1	POS.2
II	I	3.00	1.50	0.15	Ø10c/12	Ø10c/12
III	I	5.40	1.68	0.15	Ø10c/12	Ø10c/12
III-I	I	5.40	1.78	0.15	Ø10c/12	Ø10c/12

DETALLE LOSA TRANSFORMADOR  
TIPO III-I.

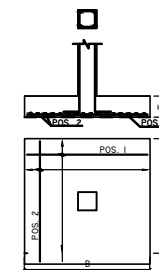

La fuerza que transforma los sueños en realidad.

Estado	
--------	--

MANTENIMIENTO Y ADECUACION CASETA SUB-ESTACION ELECTRICA  
PLANTA ENGARRAFADORA DE GLP - PUERTO SUAREZ

DIRECTOR DE PROYECTOS Y OPERACIONES: ING. PAULO ARCE S.

---

[illegible]

DISEÑO:	ING. JUAN JOSE JIMENEZ.	A 8000
---------	-------------------------	--------

DIBUJO:	ING. JUAN JOSE JIMENEZ.	
---------	-------------------------	--

Título: PLANOS ESTRUCTURALES

	CODIGO:
--	---------

--	--

Escala: 1:100

CODIGO:

N° de Laminar:

01/01